



# HIVE CONTROLLER

# DSHE-01

## Instruction Manual



We sincerely thank you for purchasing our HIVE CONTROLLER.  
Please read the instruction manual carefully and use it according to the purpose.

Be sure to read “Storage and Handling Precautions” before use.

The warranty card is printed on the back cover.  
Make sure that the date of purchase and the place of sale are correctly entered.  
Please keep it so that it is not lost.

There may be some differences between the illustrations  
in the instruction manual and the actual product shape.  
Thank you for your understanding.

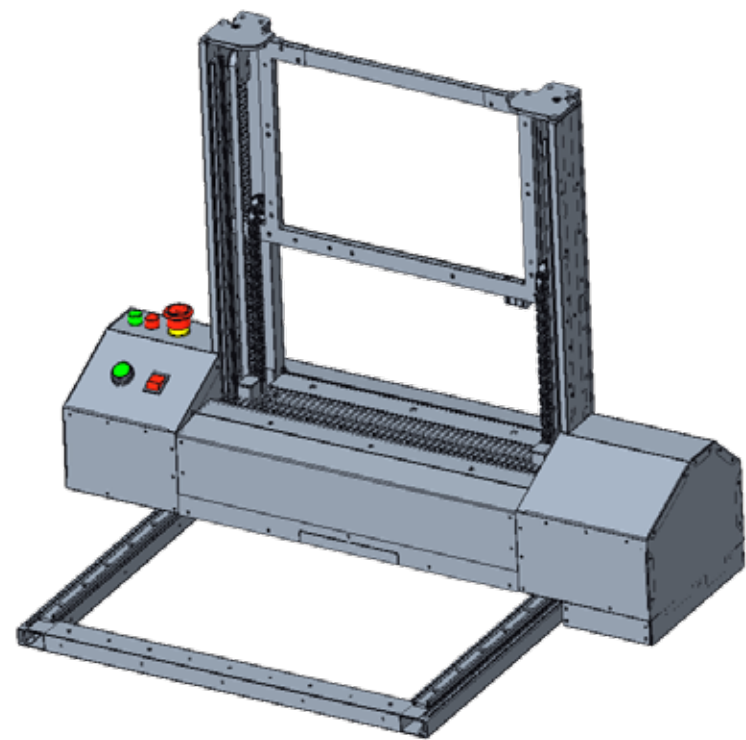

CONTENTS

1. Product Appearance	3p
2. Name of the part	
● Control part	4p
● Main part	5p
3. How to Use	
● To use Main part	6p
● To use Extraction device	7p
● Emergency	8p
4. How to install the optional product	
● To install Hive rack	9p
● To install Extraction device	10p
5. Product Composition	11p
6. Cautions	12p
7. Check before reporting a failure	13p
8. Warranty	14p

# 01. Product Appreance

● Product Image



● Product Specification

Model Name	DSHE-01
Production	DAESUNG   SMART HIVE
Version	REV2(210306),Ver20-R03, TALBONG-V20-r10
Size	873 X 561 X 577mm ( W x D x H mm)
Weight	9kg
Power	24V DG Adapter (Power Supply)
Material	Aluminum

# 02. Name of the part

● Control part

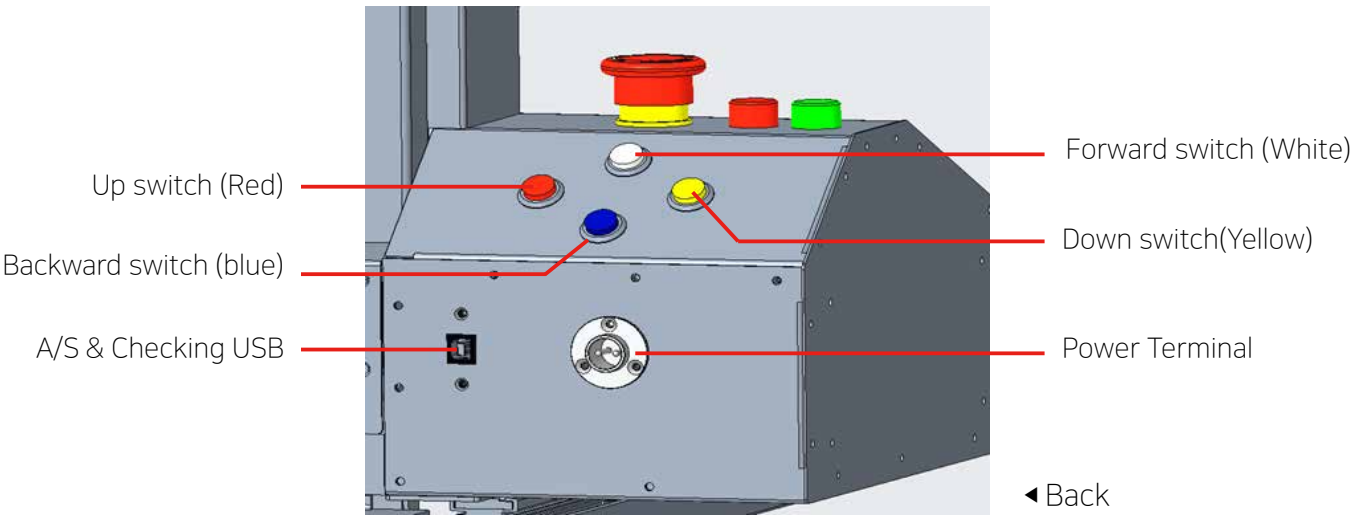
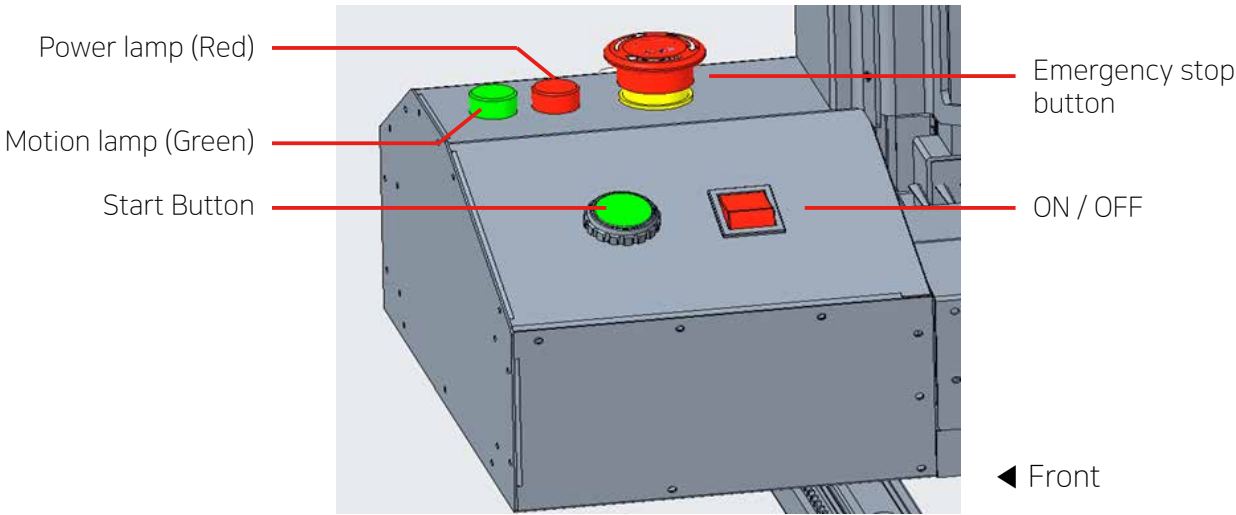
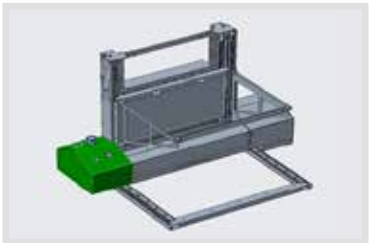

## 02. Name of the part

● Main part

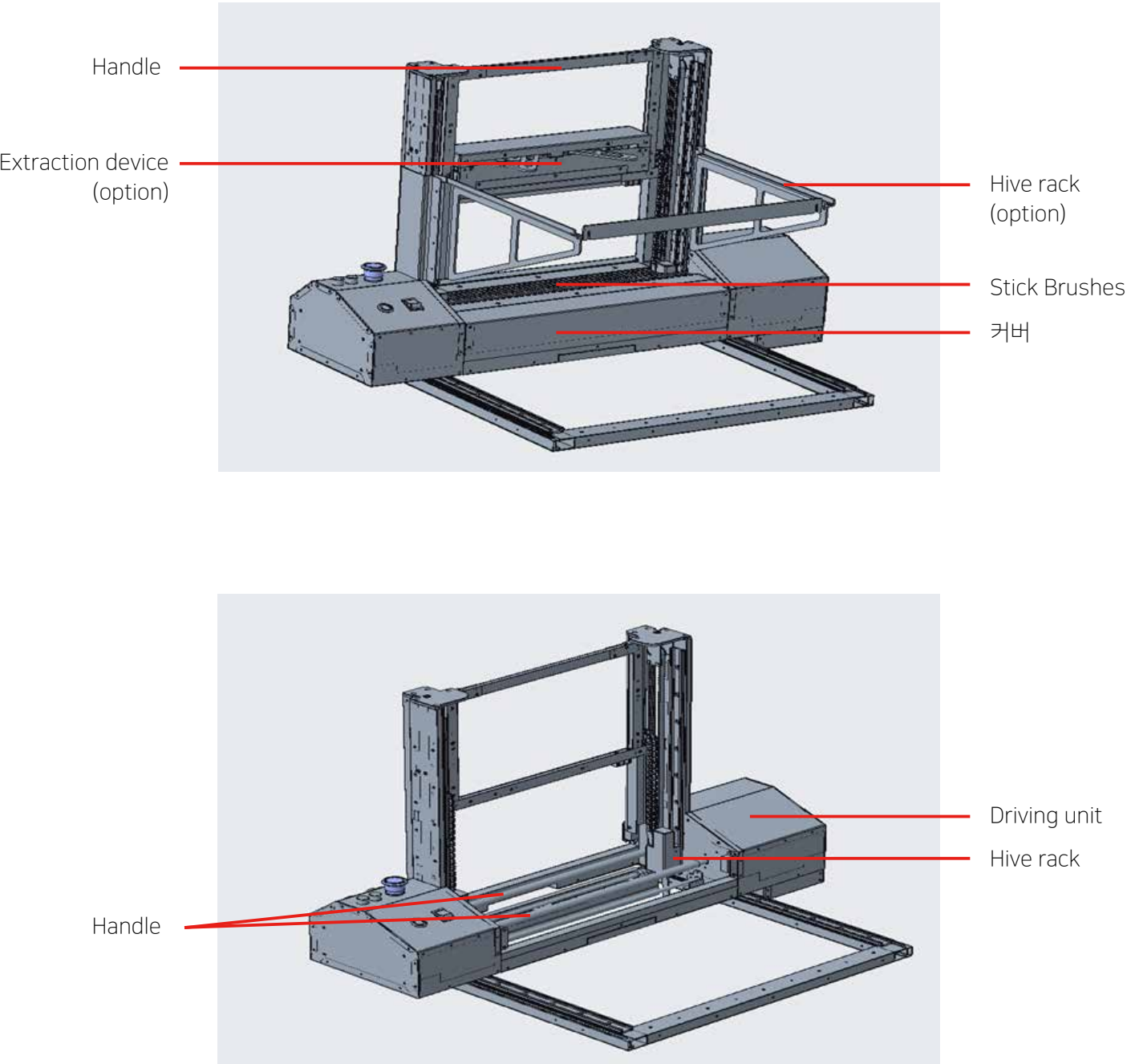

## 03. How to Use

● To use Main part

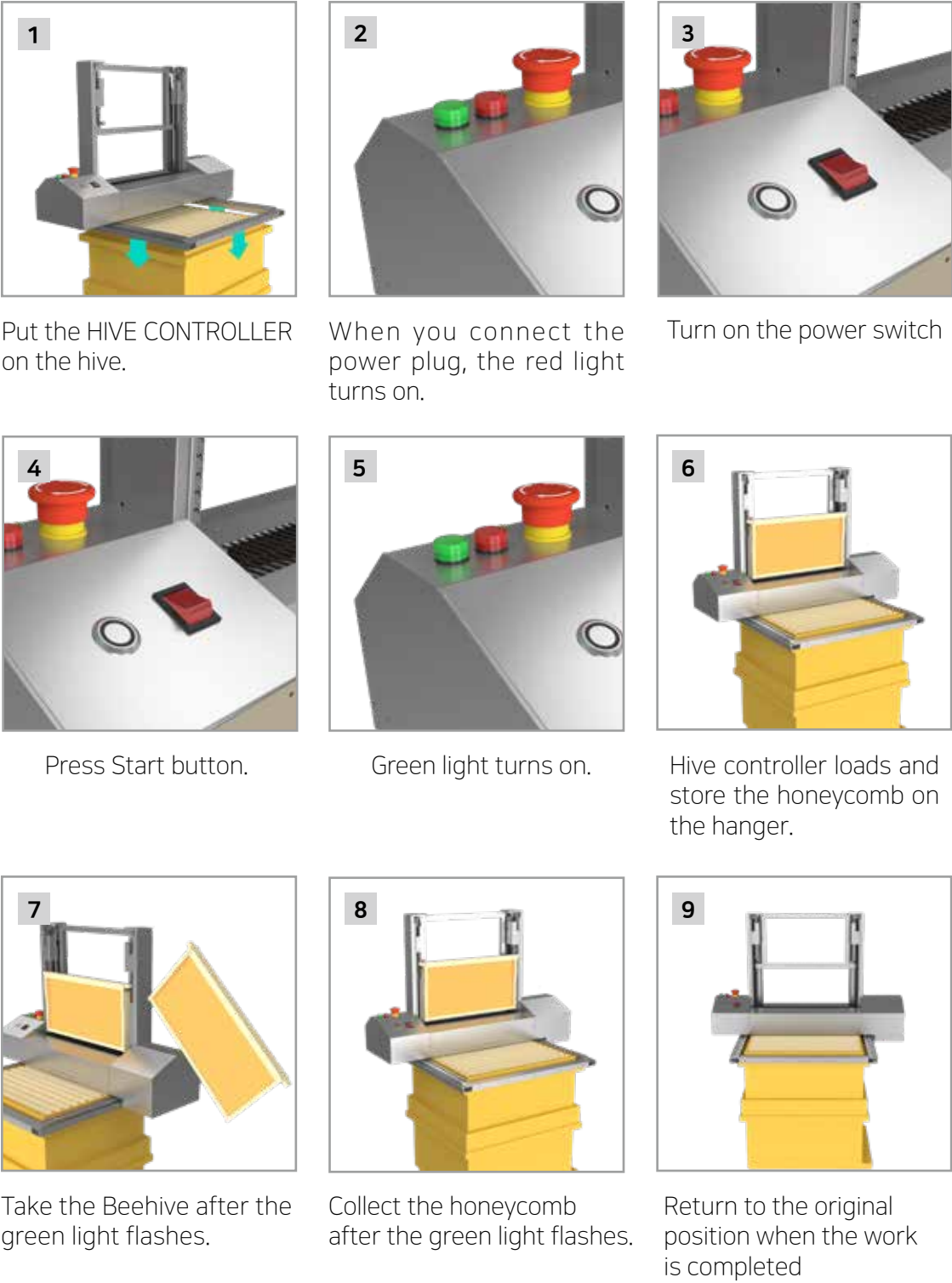



# 03. How to Use

● To use Extraction device



Put the HIVE CONTROLLER on the hive.



When you connect the power plug, the red light turns on.



Turn on the power switch



Press Start button.

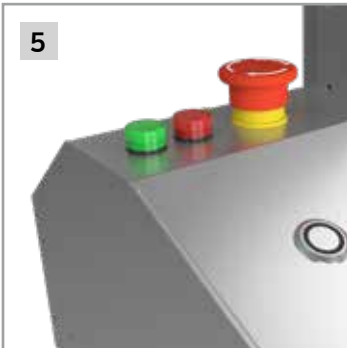

Green light turns on.



Hive controller loads and store the honeycomb on the hanger.



When the green light flashes, the hive moves to the hive rack.



When the hive moves to the hive rack, the next hive is withdrawn.



Return to the original position when the work is completed

● Emergency



If you press the emergency switch, the red light flashes.

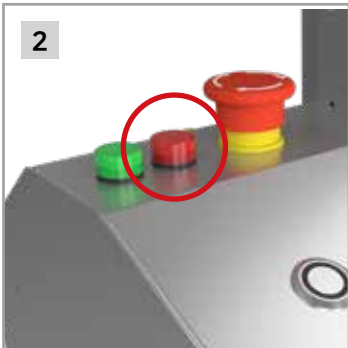

If an emergency occurs during operation, the product can be stopped by pressing the emergency button.



Turn the emergency switch clockwise (right) to release the emergency.  
*(The following functions work only when the emergency is lifted)*

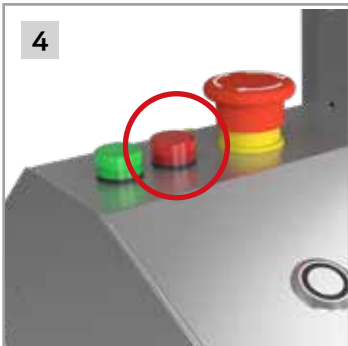

Check if the red light has turned on.



Press the button (up/down/front/back) of the operation unit to remove the jam/stick.  
*(It does not work until the emergency switch is pressed for normal operation of the product.)*

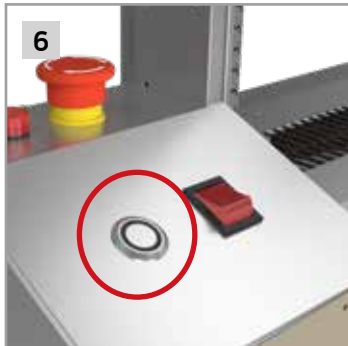

press the start button then the product works again.

## 04. How to install the optional product

- To install Hive rack

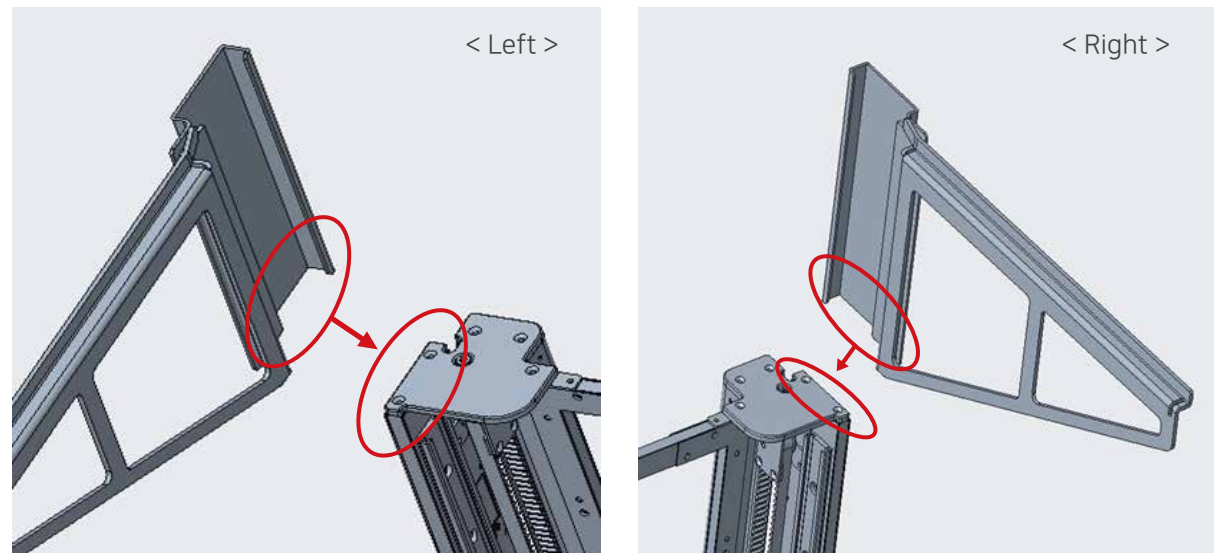

01. Insert the Hive rack into the gouge in the red circle.

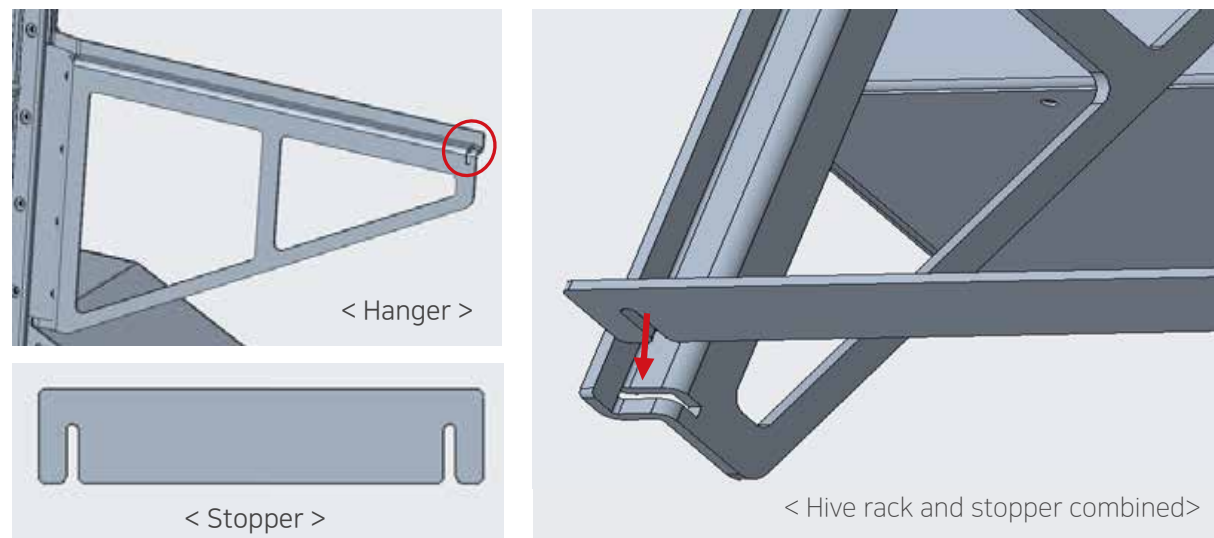

02. Insert the stopper into the gauge of the Hive rack mounted on the Hive controller.  
03. Slightly pull the Hive rack in the opposite direction and insert the other side of the stopper.

- To install Extraction device

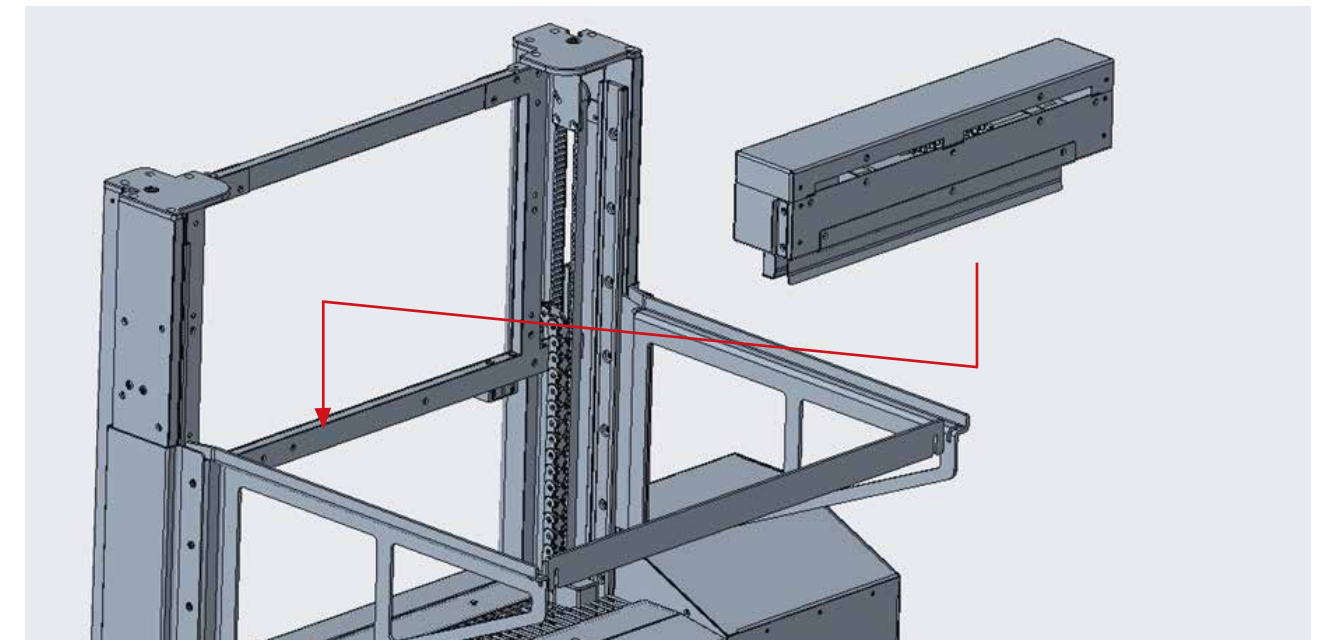

01. Push the [Extraction device] in front of the post-rebellion machine.

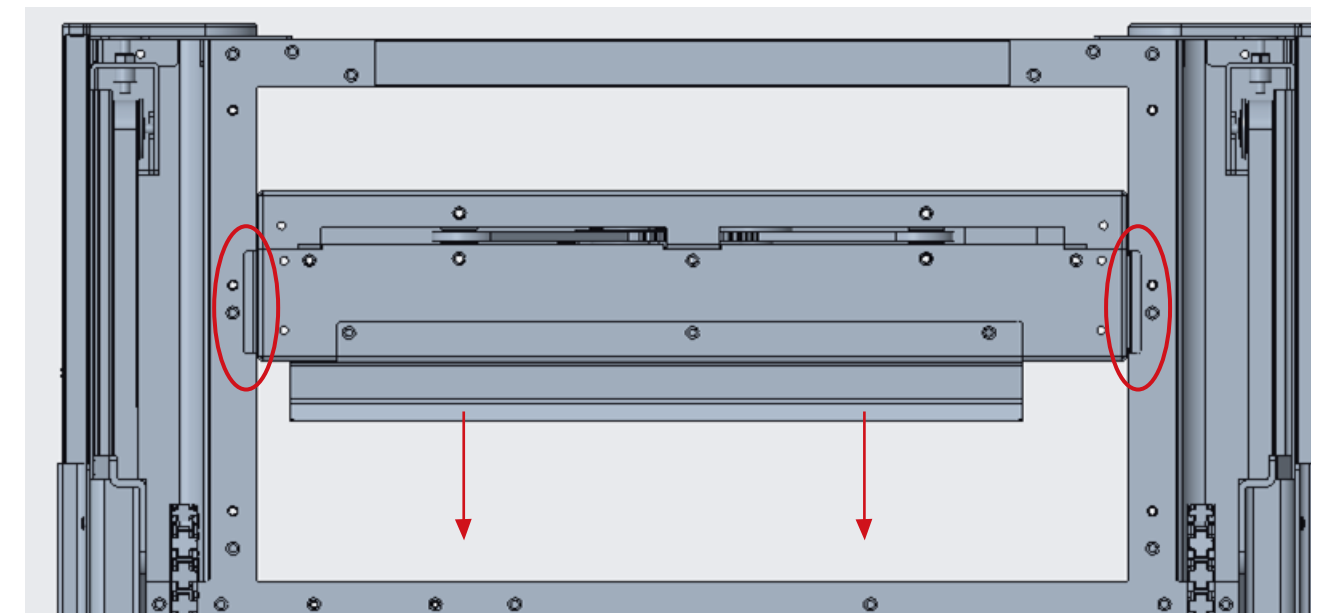

02. The wing portion (inside the red circle) of the Extraciton device is brought into close contact with the main body  
03. Lower the extraction body down to complete the installation.

## 05. Product Composition

### ● body

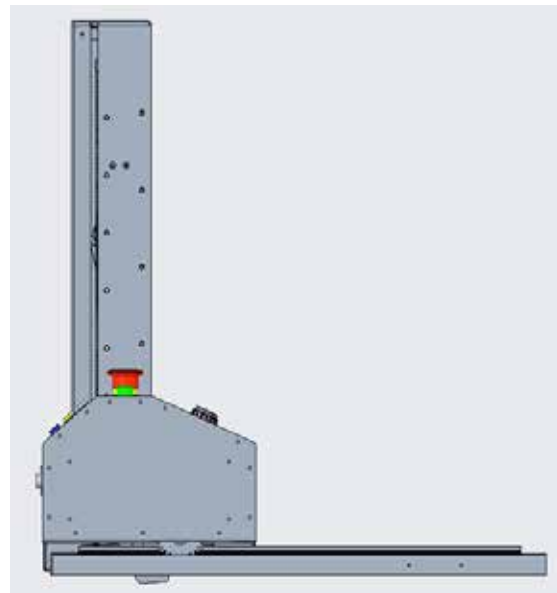

< side >

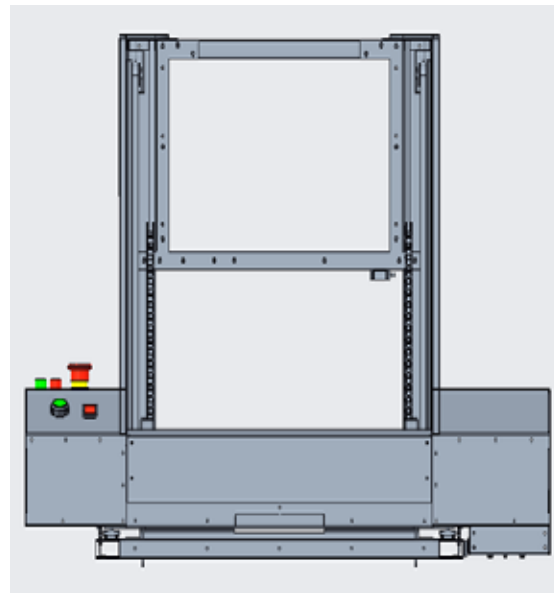

< front >

### ● Extraction device (option)

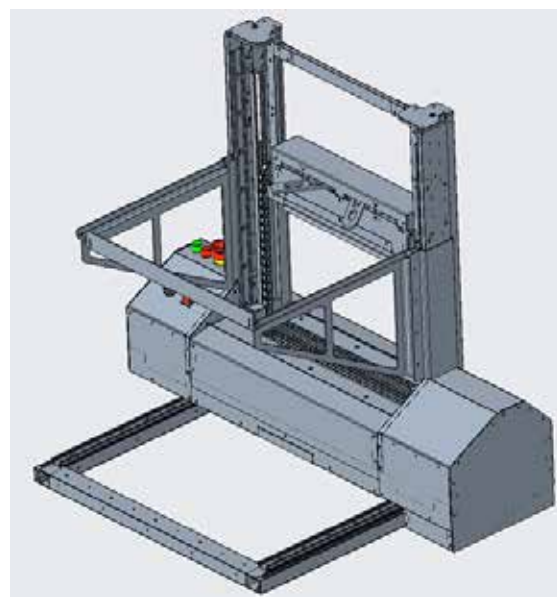

### ● Adapter (Power Supply)



- Instruction
- Warranty Card
- Battery (option)

## 06. Cautions

- Store in a dry place after use.
- When cleaning the product, the desorables (beebrush, cover, etc.) can be washed with water after desorption. However, when washing the main body, wash it with a wet towel or the like and wipe the water with a dry towel.  
(When the main body is washed with water, damage to the product causes failure and malfunction.)
- When using, do not throw or apply excessive force.  
(This product may damage the product if it is shocked by an electronic product. Please note that warranty will not be available if product defects occur due to impact during transportation or storage.)
- In case of rain, be careful not to expose the product to rain (risk of electric shock).
- Be careful not to damage or scratch the device.
- Do not store with rain, wind, moisture, dust, harmful gases, chemicals (volatile substances such as thinner and benzene), direct sunlight or heating elements such as stoves. Damage to the product may cause failure or malfunction.
- This device is primarily intended for use in apiaries and can be used in all areas.
- When disposing of the product, treat it as industrial waste.



### **WARNING**

- Do not subject it to excessive impact, such as dropping it from a high place.
- Do not use the product in rainy weather as there is a risk of electric shock.
- This product is made based on standardized beehives.  
There is a risk of malfunction or damage when used in beehives outside the standard, so please be careful of the use.



07. Check before reporting a failure.

Symtom	Cause and solution.
The power is not on.	<b>Main power is not connected.</b> <ul style="list-style-type: none"><li>● Please connect the main power. The main power switch is off.</li><li>● Please turn on the main power switch.</li></ul>
It doesn't work even if you press the start button.	<b>The emergency switch is pressed.</b> <ul style="list-style-type: none"><li>● Turn the emergency switch to the right and release the emergency switch.</li></ul>
It does not work even when the manual switch is pressed.	<b>It's an error in how to operate.</b> <ul style="list-style-type: none"><li>● Press and release the emergency switch before using it</li></ul>
When you press the start button, the honeycomb ring comes down and goes up immediately.	<b>There are too many hives in the beehives.</b> <ul style="list-style-type: none"><li>● Remove 1-2 hives from the beehives and use them again.</li></ul>
The Extraction device is not working	<b>Extraction Device faulty contact</b> <ul style="list-style-type: none"><li>● Please check the combination of the extraction device and the main body.</li></ul>
It's not running on the battery.	<b>The battery is completely discharged.</b> <ul style="list-style-type: none"><li>● Please charge the battery.</li></ul>

WARRANTY CARD

This product is guaranteed for the product as follows in accordance with the consumer damage compensation regulations for each item.  
Conduct. If any abnormality is found on the product, please contact the following warranty inquiries.

1. When requesting product service, please submit the following information.  
-Purchase date, place of purchase, proof of purchase  
This is limited to use under normal conditions of use.
2. Free service: The free service period of the product is one year from the date of purchase.  
-When a failure occurs due to a performance or functional problem occurring under normal use. We provide free repair service for manufacturing defects only.
3. Paid service: Even within the warranty period, paid repair service is provided in the following cases.  
Provided. Failure and product due to consumer carelessness or discretionary disassembly, repair, or modification  
Damage (shock, high temperature, etc.) If the free warranty period warns, or improper handling or Damage caused by natural disasters

\* Consumer consultation and warranty inquiry: 070-4354-4504

Model	DSHE-01
Warranty Period	1 year from the date of purchase.
Place of purchase	

● Customer Info.

Name	
Address	
Contact	





**Production by DAESUNG | SMART HIVE**

Head office | 109, Ballyong-ro, Deokjin-gu, Jeonju-si, Jeollabuk-do, Republic of Korea

Branch office | 147, Daehwa-ro, Daedeok-gu, Daejeon, Republic of Korea

TEL | +82 70 4354 4504 / E-mail | [ceo@smarthive.co.kr](mailto:ceo@smarthive.co.kr)